

940nm 50mW~60mW PM Fiber Coupled Laser Diode with Coaxial Package | Infrared LD Module
940nm~950nm 50mW Coaxial Pigtailed LD with Polarization Maintaining Fiber (SM Fiber)
RWLP-940-050m-PM-PD

940nm Pigtailed Diode Laser		50mW/PM Fiber	
PARAMETER	SYMBOL	VALUE	UNIT
Reverse Voltage	V_r	2.0	V
Operating Temperature	T_{op}	-10~+60	°C
Storage Temperature	T_{stg}	-40~+85	°C
Lead soldering temperature (10 sec.)	T_{is}	260	°C
Features: <ul style="list-style-type: none"> 940nm PM Fiber High Reliability High Polarization Extinction Ratio Applications: <ul style="list-style-type: none"> Biological Instruments Analytical Equipment Others 			
Specifications	RWLP-940-050m-PM-PD		
	Min	Type	Max
Center Wavelength@25°C	940nm±15nm		
Recommended work Temperature	25°C		
Output Power	----	50mW	----
Fiber Type	Polarization Maintaining Fiber		
Fiber Core	5um		
Polarization Extinction Ratio	13dB	15dB	----
Monitor Current	----	0.3mA	----
Fiber Connector	FC/APC		
Fiber Length	>80cm		
Threshold Current (Typ.)	----	25mA	55mA
Operating Current (Typ.)	----	280mA	300mA
Operating Voltage	----	2.2V	2.8V
Package Style	Coaxial or B82		
High Polarization Extinction Ratio (PER) Version Laser Module is also available, please contact us.			

Coaxial Package View: (Part Number: RWLP-940-050m-PM-PD)

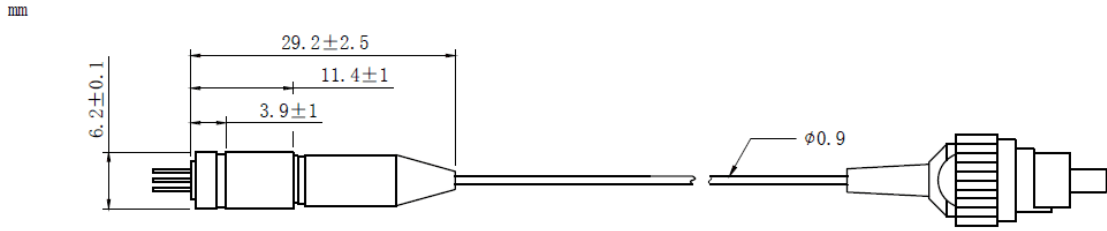

B82 Package View: (Part Number: RWLP-940-050m-PM-B-PD)

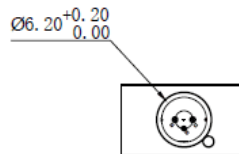
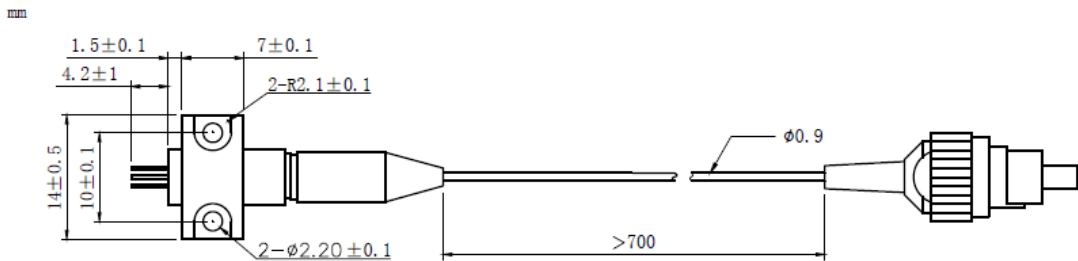

PIN Bottom View:

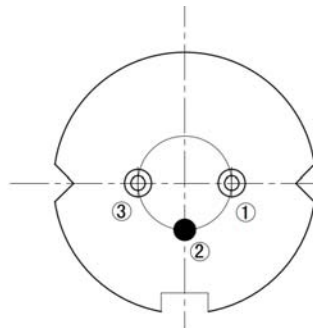

1	LD(-)
2	LD(+)&PD(-)
3	PD(+)

Electrically shorten LD module and store in non-extreme conditions.
Suggest using the constant current power supply.

