

940nm~950nm 30mW~40mW SM Coaxial Pigtailed Laser Diode with Single Mode Fiber
940nm | 30mW | High Power Single Mode Fiber Coupled Diode Laser Module | Built-in PD | SMF LD Module
RWLP-940-030m-4-PD

940nm Pigtailed Diode Laser		30mW/SMF	
PARAMETER	SYMBOL	VALUE	UNIT
Reverse Voltage	V_r	2.0	V
Operating Temperature	T_{op}	-10~+60	°C
Storage Temperature	T_{stg}	-40~+85	°C
Lead soldering temperature (10 sec.)	T_{is}	260	°C
Features: <ul style="list-style-type: none"> ● 940nm ● Single Mode Fiber ● Coaxial or B82 Package ● Built-in PD 			
Applications: <ul style="list-style-type: none"> ● Medical Laser Treatment ● Sensor ● Others 			
Specifications	RWLP-940-030m-4-PD		
	Min	Type	Max
Center Wavelength@25°C	940nm±15nm		
Recommended Operating Temperature	25°C		
Output Power	----	30mW	----
Fiber Type	Single Mode Fiber		
Fiber Core	5um		
Monitor Current	----	0.3mA	----
PD Reverse Voltage	----	----	30V
Fiber Connector	FC/SC/SMA905		
Fiber Length	>80cm		
Threshold Current (Typ.)	----	20mA	45mA
Operating Current (Typ.)	----	220mA	240mA
Operating Voltage	----	2.1V	2.6V
Package Style	Coaxial or B82		
Photodiodes	Built-in		

Coaxial Package View: (Part Number: RWLP-940-030m-4-PD)

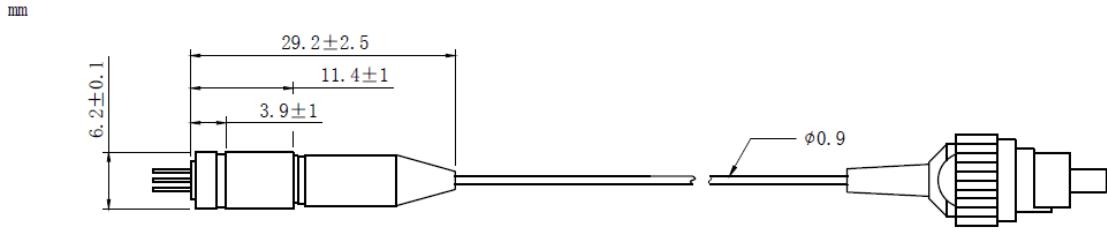

B82 Package View: (Part Number: RWLP-940-030m-4-B-PD)

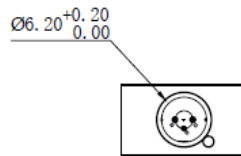
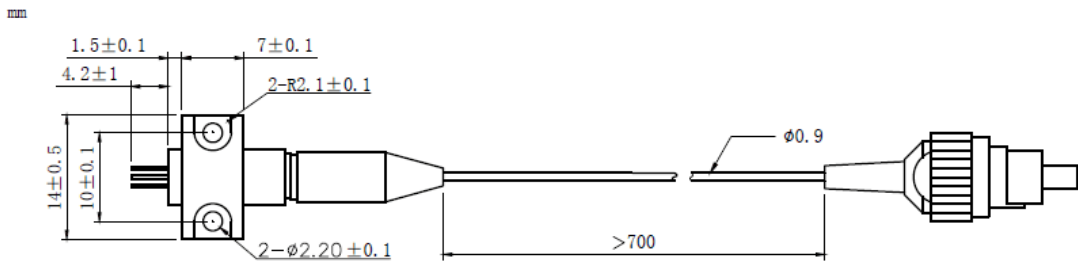

PIN Bottom View:

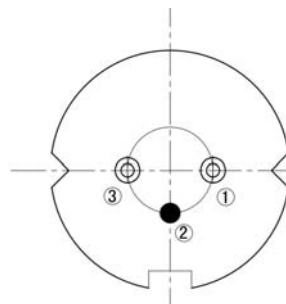

1	LD(-)
2	LD(+) & PD(-)
3	PD(+)

Electrically shorten LD module and store in non-extreme conditions.
Suggest using the constant current power supply.

