

850nm 2mW~3mW SM Coaxial Pigtailed Laser Diode with 9um Fiber | Infrared Diode Laser Module

850nm 2mW Fiber Coupled LD with SMF-28 Fiber | Built-in Photodiode (PD)

RWLP-850-002m-9-PD

850nm Pigtailed Diode Laser		2mW/9um Fiber	
PARAMETER	SYMBOL	VALUE	UNIT
Reverse Voltage	V_r	2.0	V
Operating Temperature	T_{op}	-10~+60	°C
Storage Temperature	T_{stg}	-40~+80	°C
Lead soldering temperature (10 sec.)	T_{is}	260	°C
Features: <ul style="list-style-type: none"> ● 850nm ● With 9um SM Fiber ● Coaxial or B82 Package ● Built-in PD 			
Applications: <ul style="list-style-type: none"> ● Medical Laser Treatment ● Sensor ● Others 			
Specifications	RWLP-850-002m-9-PD		
	Min	Type	Max
Center Wavelength@25°C	840nm	850nm	860nm
Recommended Operating Temperature	25°C		
Output Power	----	2mW	----
Fiber Type	SMF-28		
Fiber Core	9um		
Monitor Current	----	0.2mA	----
PD Reverse Voltage	----	----	30V
Fiber Connector	FC/SC/SMA905		
Fiber Length	>80cm		
Threshold Current (Typ.)	----	10mA	20mA
Operating Current (Typ.)	----	25mA	30mA
Operating Voltage	----	1.9V	2.6V
Package Style	Coaxial or B82		
Photodiodes	Built-in		

Coaxial Package View: (Part Number: RWLP-850-002m-9-PD)

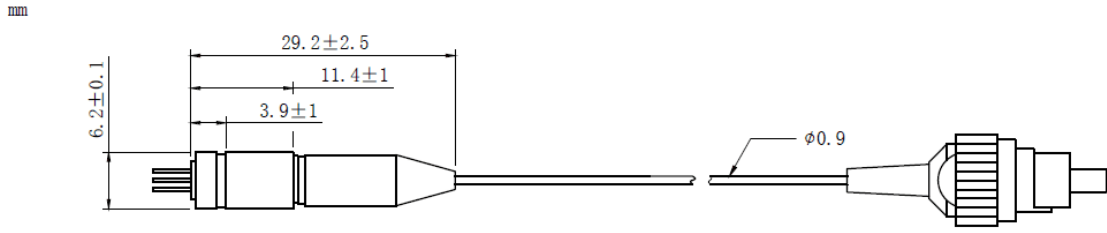

B82 Package View: (Part Number: RWLP-850-002m-9-B-PD)

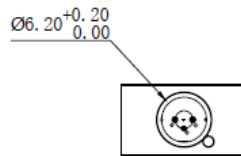
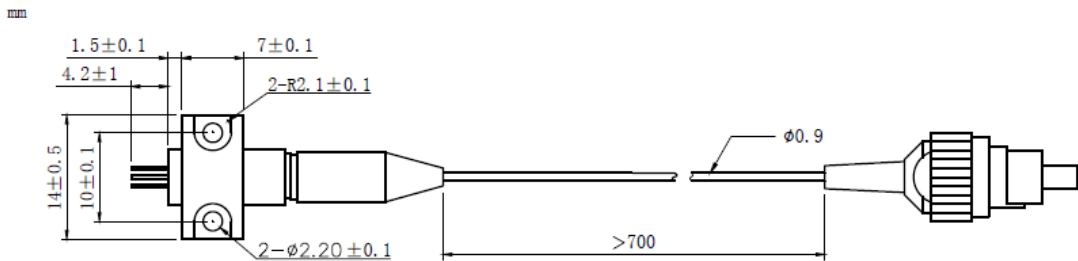

PIN Bottom View:

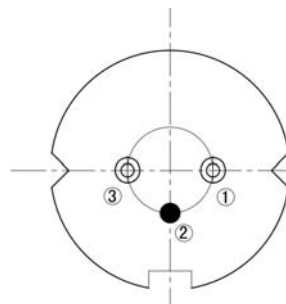

1	LD(-)
2	LD(+)&PD(-)
3	PD(+)

Electrically shorten LD module and store in non-extreme conditions.
Suggest using the constant current power supply.

