

650nm~660nm 80mW SM Coaxial Pigtailed Laser Diode with Polarization Maintaining Fiber (PM Fiber)
658nm 80mW High Power PM Fiber Coupled Diode Laser Module| Polarization Maintaining Fiber (PMF)
RWLP-650-080m-PM

| 658nm Pigtailed Diode Laser | | 80mW/PM Fiber | |
|--|--|---------------|-------|
| PARAMETER | SYMBOL | VALUE | UNIT |
| Reverse Voltage | V_r | 2.0 | V |
| Operating Temperature | T_{op} | -10~+60 | °C |
| Storage Temperature | T_{stg} | -40~+85 | °C |
| Lead soldering temperature (10 sec.) | T_{is} | 260 | °C |
| Features: <ul style="list-style-type: none"> ● 650nm ● 4um PM Fiber ● High Stability ● High Polarization Extinction Ratio |  | | |
| Applications: <ul style="list-style-type: none"> ● Medical Laser Treatment ● Others | | | |
| Specifications | RWLP-650-080m-PM | | |
| | Min | Type | Max |
| Center Wavelength@25°C | ±5nm | 658nm | ±10nm |
| Recommended Operating Temperature | 25°C | | |
| Output Power | ---- | 80mW | ---- |
| Fiber Type | Polarization Maintaining Fiber | | |
| Fiber Core | 4um | | |
| Polarization Extinction Ratio | 13dB | 15dB | |
| Fiber Length | ---- | 80cm | 100cm |
| Threshold Current | ---- | 55mA | 85mA |
| Operating Current | ---- | 220mA | 240mA |
| Operating Voltage | ---- | 2.8V | 3.5V |
| Fiber Connector | FC/APC | | |
| Package Style | Coaxial or B82 | | |
| High Polarization Extinction Ratio (PER) Version Laser Module is also available, please contact us. | | | |

Coaxial Package View: (Part Number: RWLP-650-080m-PM)



B82 Package View: (Part Number: RWLP-650-080m-PM-B)

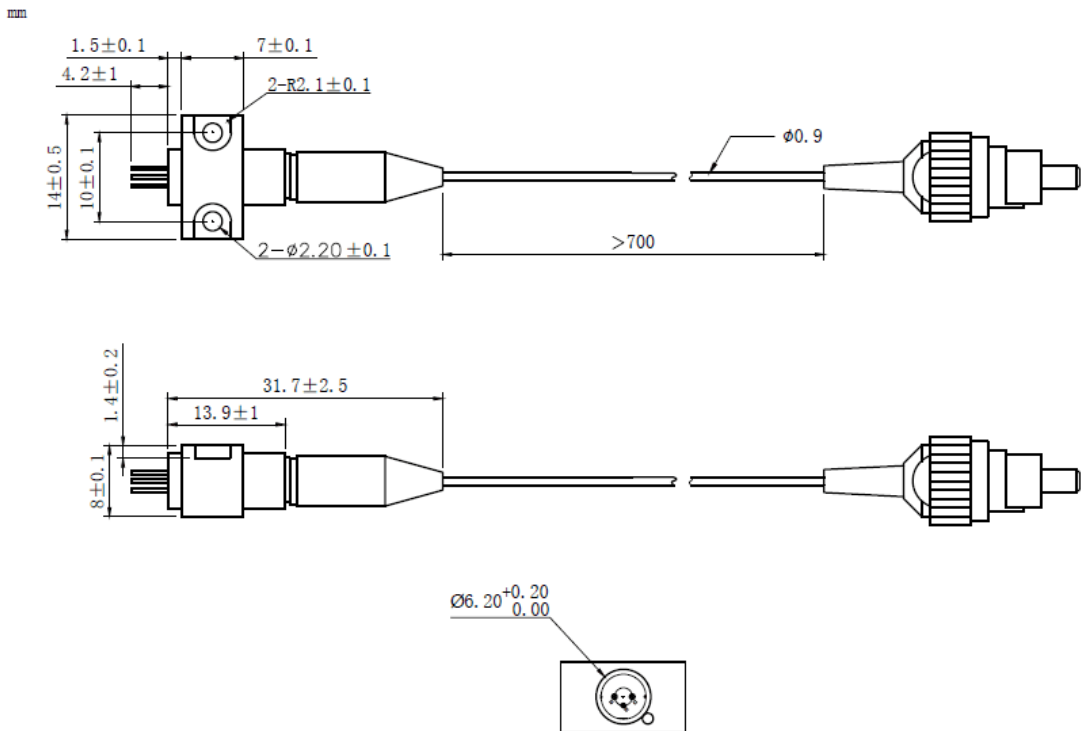

PIN Bottom View:

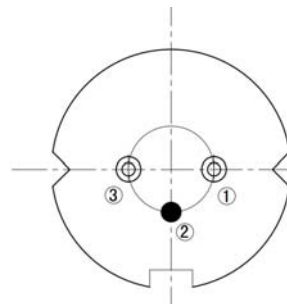

| | |
|---|-------|
| 1 | LD(+) |
| 2 | LD(-) |
| 3 | NC |

Electrically shorten LD module and store in non-extreme conditions.
Suggest using the constant current power supply.

