

650nm~660nm 5mW SM Coaxial Pigtailed Laser Diode with SMF | Built-in Photodiodes (PD)

660nm SM Fiber Coupled LD with Single Mode Fiber (SM Fiber) |With PD

RWLP-650-005m-4-PD

658nm Pigtailed Diode Laser		5mW/SM Fiber	
PARAMETER	SYMBOL	VALUE	UNIT
Reverse Voltage	V_r	2.0	V
Operating Temperature	T_{op}	-10~+60	°C
Storage Temperature	T_{stg}	-40~+85	°C
Lead soldering temperature (10 sec.)	T_{is}	260	°C
Features: <ul style="list-style-type: none"> 🔸 658nm 🔸 4um SM Fiber 🔸 Coaxial or B82 Package 🔸 Built-in PD 			
Applications: <ul style="list-style-type: none"> 🔸 Medical Laser Treatment 🔸 Others 			
Specifications	RWLP-650-005m-4-PD		
	Min	Type	Max
Center Wavelength@25°C	658nm±10nm		
Recommend Operating Temperature	25°C		
Output Power	----	5mW	----
Fiber Type	Single Mode Fiber		
Fiber Core	4um		
Monitor Current	----	0.3mA	----
PD Reverse Voltage	----	----	30V
Fiber Connector	FC/SC/SMA905		
Fiber Length	>80cm		
Threshold Current	----	35mA	50mA
Operating Current	----	65mA	80mA
Operating Voltage	----	2.4V	3.0V
Package Style	Coaxial or B82		
Photodiodes	Built-in		

Coaxial Package View: (Part Number: RWLP-650-005m-4-PD)

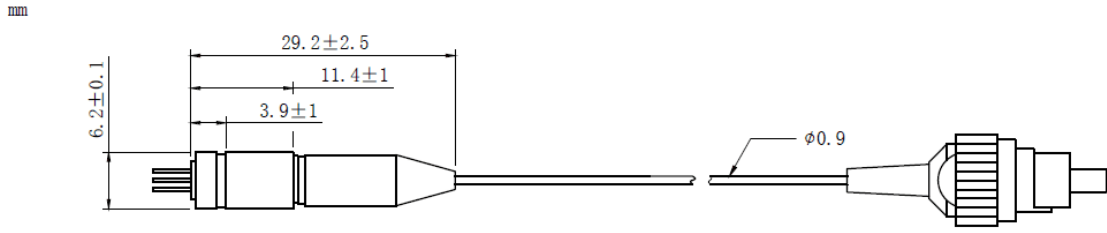

B82 Package View: (Part Number: RWLP-650-005m-4-B-PD)

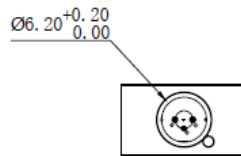
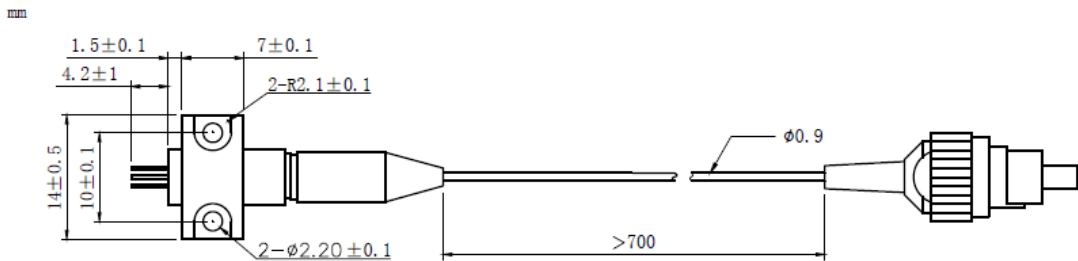

PIN Bottom View:

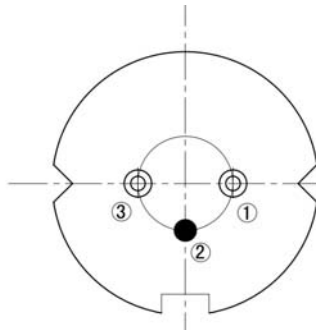

1	LD(-)
2	LD(+)&PD(-)
3	PD(+)

Electrically shorten LD module and store in non-extreme conditions.
Suggest using the constant current power supply.

