

**635nm~638nm 100mW Single Mode Fiber Coupled Diode Laser with Photodiode (PD)**  
**635nm 100mW Coaxial Pigtailed Laser Diode with 4um Single Mode Fiber (SM Fiber)**  
**RWLP-635-100m-4-PD**

635nm Pigtailed Diode Laser 100mW/SMF			
PARAMETER	SYMBOL	VALUE	UNIT
Reverse Voltage	$V_r$	2.0	V
Operating Temperature	$T_{op}$	-10~+60	°C
Storage Temperature	$T_{stg}$	-40~+85	°C
Lead soldering temperature (10 sec.)	$T_{is}$	260	°C
<b>Features:</b> <ul style="list-style-type: none"> <li>● 635nm</li> <li>● 4um SM Fiber</li> <li>● Coaxial or B82 Package</li> <li>● Built-in PD</li> </ul>			
<b>Applications:</b> <ul style="list-style-type: none"> <li>● Medical Laser Treatment</li> <li>● Aiming Beam</li> <li>● Others</li> </ul>			
<b>Specifications</b>	<b>RWLP-635-100m-4-PD</b>		
	Min	Type	Max
Center Wavelength@25°C	630nm	638nm	645nm
Recommended work Temperature	25°C		
Output Power	----	100mW	----
Fiber Type	Single Mode Fiber		
Fiber Core	4um		
Monitor Current	----	0.3mA	----
PD Reverse Voltage	----	----	30V
Fiber Connector	FC/SC/SMA905		
Fiber Length	----	80cm	100cm
Threshold Current	----	70mA	100mA
Operating Current	----	280mA	300mA
Operating Voltage	----	2.8V	3.5V
Package Style	Coaxial or B82		
PD	Built-in		

**Coaxial Package View: (Part Number: RWLP-635-100m-4-PD)**



**B82 Package View: (Part Number: RWLP-635-100m-4-B-PD)**

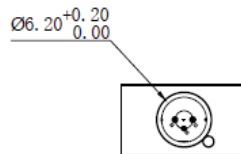
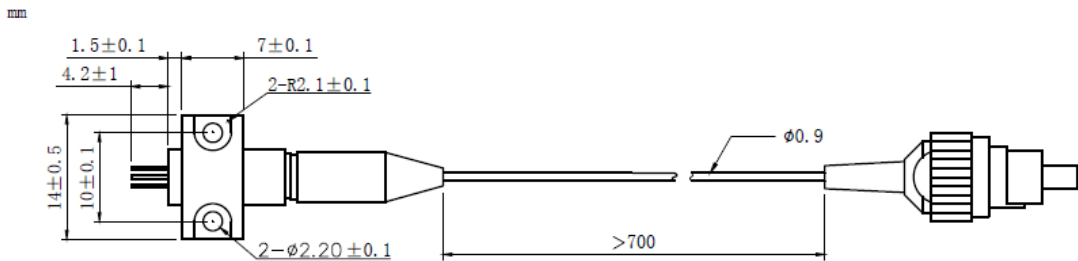

**PIN Bottom View:**

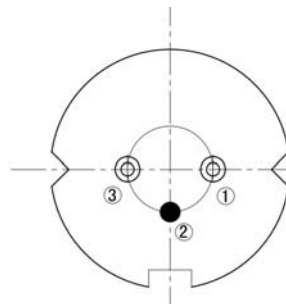

1	LD(-)
2	LD(+) & PD(-)
3	PD(+)

Electrically shorten LD module and store in non-extreme conditions.  
Suggest using the constant current power supply.

