

**400nm 15mW~20mW PM Pigtailed Laser Diode Module With Polarization Maintaining Fiber**  
**400nm~402nm 15mW PM Fiber Coupled Diode Laser Module | Violet LD Module | Built-in PD**  
**RWLP-400-015m-PM-PD**

| 400nm Pigtailed Diode Laser 15mW/PMF   |  |         |       |
|--|--|---------|-------|
| PARAMETER  | SYMBOL   | VALUE   | UNIT  |
| Reverse Voltage  | $V_r$  | 2.0     | V     |
| Operating Temperature  | $T_{op}$   | -10~+70 | °C    |
| Storage Temperature  | $T_{stg}$  | -40~+85 | °C    |
| Lead soldering temperature (10 sec.)   | $T_{is}$   | 260     | °C    |
| <b>Features:</b> <ul style="list-style-type: none"> <li>● 400nm</li> <li>● PM Fiber</li> <li>● High Reliability</li> <li>● High Polarization Extinction Ratio</li> </ul> |  |         |       |
| <b>Applications:</b> <ul style="list-style-type: none"> <li>● Medical Laser Treatment</li> <li>● Biotechnology</li> <li>● Others</li> </ul>                              |  |         |       |
| <b>Specifications</b>  | <b>RWLP-400-015m-PM-PD</b>   |         |       |
|  | Min  | Type    | Max   |
| Center Wavelength@25°C   | 400nm±5nm  |         |       |
| Spectral Width (FWHM)  | ----   | 2.0nm   | ----  |
| Output Power   | ----   | 15mW    | ----  |
| Fiber Type   | UV Polarization Maintaining Fiber  |         |       |
| Fiber Core   | 3um  |         |       |
| Recommend Operating Temperature  | 25°C   |         |       |
| Polarization Extinction Ratio  | 13dB   | 15dB    | ----  |
| Fiber Connector  | FC/APC   |         |       |
| Fiber Length   | >80cm  |         |       |
| Threshold Current  | ----   | 35mA    | 70mA  |
| Operating Current  | ----   | 90mA    | 110mA |
| Operating Voltage  | ----   | 5.0V    | 6.0V  |
| Package Style  | Coaxial or B82   |         |       |
| High Polarization Extinction Ratio (PER) Version Laser Module is also available, please contact us.  |  |         |       |

**Coaxial Package View: (Part Number: RWLP-400-015m-PM-PD)**

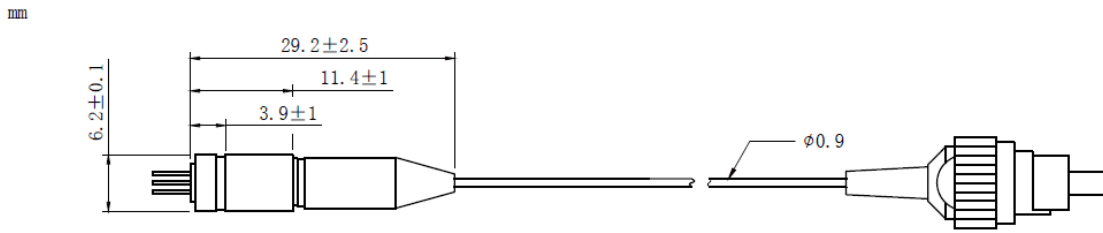

**B82 Package View: (Part Number: RWLP-400-015m-PM-B-PD)**

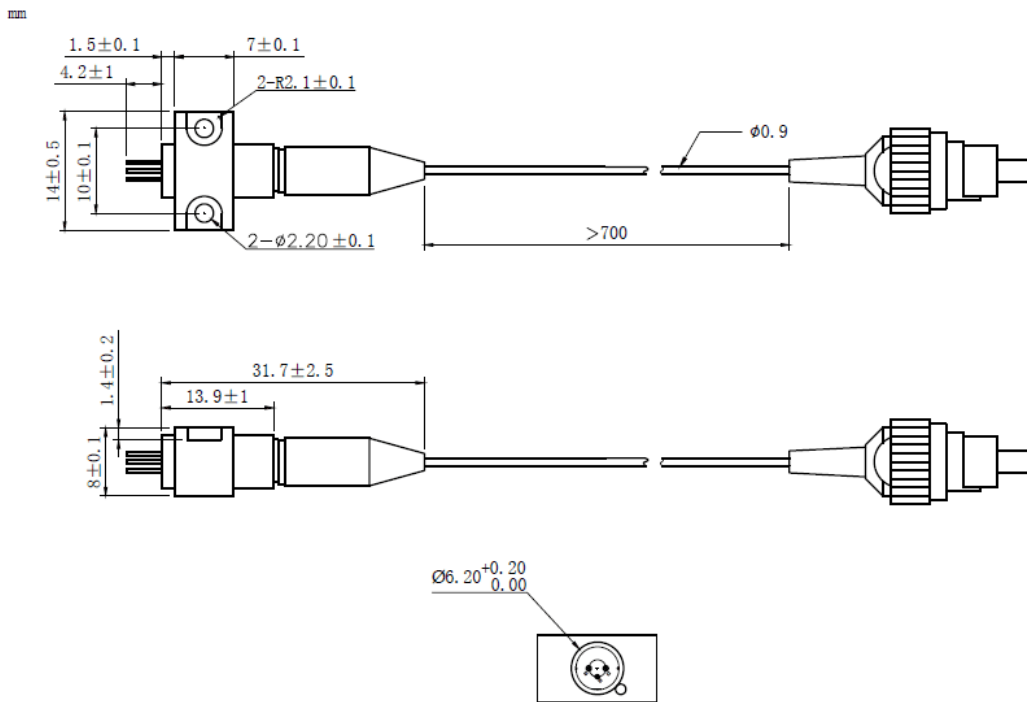

**PIN Bottom View:**

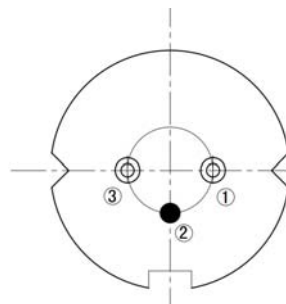

|   |               |
|---|---------------|
| 1 | LD(-)         |
| 2 | LD(+) & PD(-) |
| 3 | PD(+)         |

Electrically shorten LD module and store in non-extreme conditions.  
Suggest using the constant current power supply.

