

1550nm 5mW DFB Coaxial Pigtailed Laser Diode with 9um SMF | Isolator Optional

1550nm SM Fiber Coupled LD with Single Mode Fiber (SM Fiber)

RWLP-1550-005m-9-DFB

| PARAMETER | SYMBOL | VALUE | UNIT |
|--|-------------|--|-------------|
| LD Reverse Voltage | V_r | 2.0 | V |
| PD Reverse Voltage | $V_{r(PD)}$ | 15 | V |
| Operating Temperature | T_{op} | -20 ~ +50 | °C |
| Storage Temperature | T_{stg} | -40 ~ +100 | °C |
| Lead soldering temperature (10 sec.) | T_{is} | 260 | °C |
| Features: <ul style="list-style-type: none"> • 1550nm • DFB Laser Diode • Built-in Photodiodes • 9um SM Fiber • Isolation Optional • Coaxial or B85 Package | |  | |
| Applications: <ul style="list-style-type: none"> • Test Equipments • Optical Transmitter of Analog Signal • Optical Transmitter of Data Signal | | | |
| Specifications | | RWLP-1550-005m-9-DFB | |
| | | Min | Type |
| Center Wavelength@25°C | | ±3nm | 1550nm |
| Laser Type | | DFB | |
| Output Power | | ---- | 5mW |
| Fiber Core | | 9um SM Fiber | |
| Threshold Current (Typ.) I_{th} | | ---- | 5mA |
| Operating Current | | ---- | 60mA |
| Operating Voltage | | ---- | 1.4V |
| Spectral Width(FWHM) | | ---- | 2nm |
| SMSR | | ---- | 35dB |
| Monitor Current | | 0.1mA | ---- |
| PD Capacitance | | ---- | 10pF |
| PD Dark Current | | ---- | 0.1uA |
| Package Style | | Coaxial or B85 | |
| Recommended Operation Temperature | | 25°C | |
| Connector | | FC/SC/SMA905 | |

Coaxial Package View: (Part Number: RWLP-1550-005m-9-DFB)

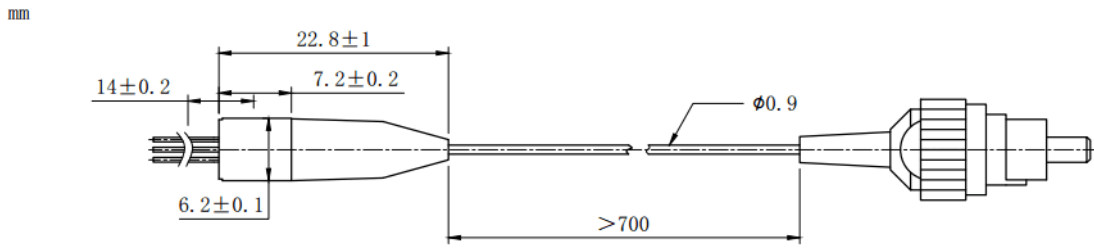

B85 Package View: (Part Number: RWLP-1550-005m-9-B-DFB)

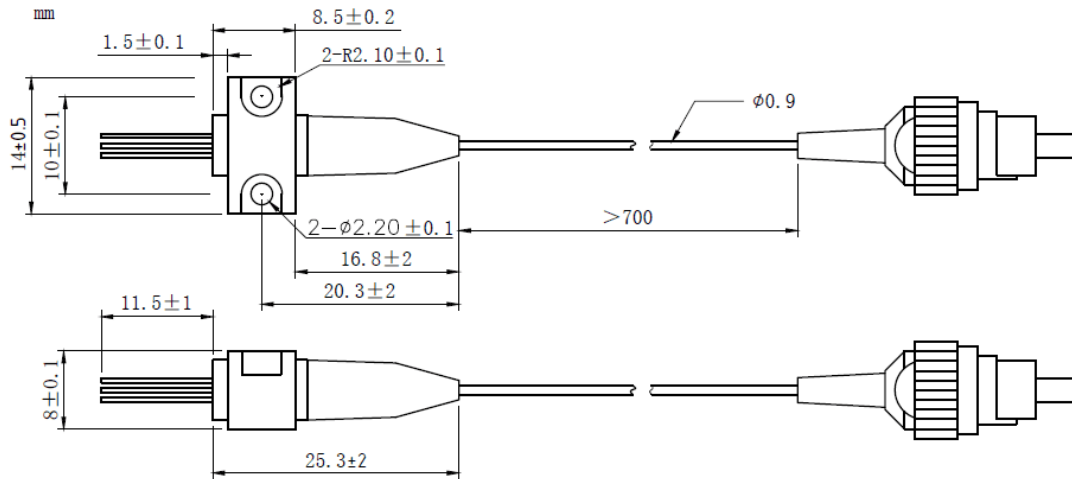

Pin Bottom View (A-Type)

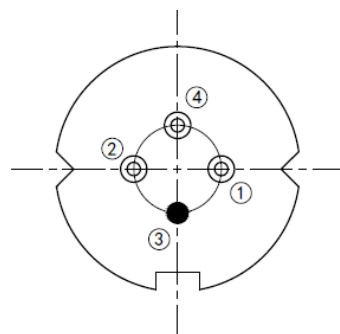

| | |
|-------|-------------|
| PIN 1 | PD(+) |
| PIN 2 | LD(-) |
| PIN 3 | LD(+), CASE |
| PIN 4 | PD(-) |

Electrically shorten LD module and store in non-extreme conditions.

Suggest using the constant current power supply.

