

**915nm 10W Laser Diode with E-mount Package | FAC Optional**  
**905nm~915nm High Power 10W LD | Square Beam Optional**  
**RWSLD-915-010-E**

915nm Laser Diode		10W/E-mount	
Reverse Voltage	$V_r$	2.0	V
Operating Temperature	$T_{op}$	+10 ~+30	°C
Storage Temperature	$T_{stg}$	-20~ +80	°C
Lead soldering temperature (10 sec.)	$T_{is}$	260	°C
<b>Features:</b> <ul style="list-style-type: none"> <li>● 915nm</li> <li>● E-mount Package</li> <li>● Square Beam Optional</li> </ul>			
<b>Applications:</b> <ul style="list-style-type: none"> <li>● Medical Laser Treatment</li> <li>● Laser Pumping</li> <li>● Other</li> </ul>			
<b>Specifications</b>	<b>RWSLD-915-010-E</b>		
	<b>Min</b>	<b>Type</b>	<b>Max</b>
Center Wavelength@25°C	915nm±10nm		
Spectral Width (FWHM)	----	4.0nm	----
Output Power	----	10W	----
Emitter Area	100x1µm		
Beam Divergence (FWHM)	----	30° <sub>⊥</sub> x 8° <sub>//</sub>	----
Temperature Coefficient of Wavelength	----	0.3nm / °C	----
Slope Efficiency	----	1.0W/A	----
Threshold Current (Typ.)	----	0.5A	1.5A
Operating Current (Typ.)	----	10.5A	11.0A
Operating Voltage	----	1.7V	2.1V
Package Style	E-mount		
Recommended Operating Temperature	25°C		

## E-mount Package View

mm

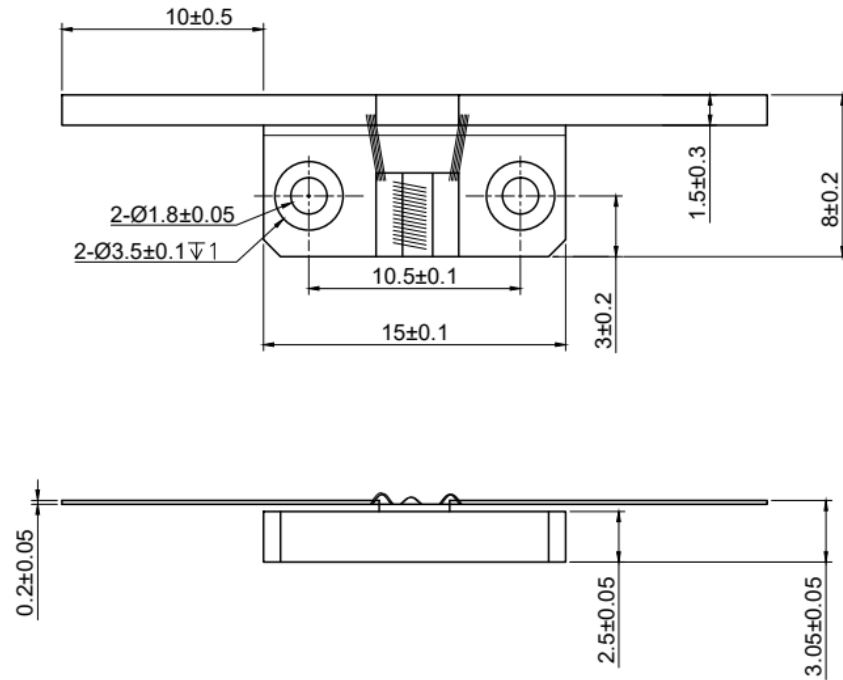

**Electrically shorten LD module and store in non-extreme conditions.**  
**Suggest using the constant current power supply.**

