

905nm Pigtailed Diode Laser		50mW/MM Fiber	
PARAMETER	SYMBOL	VALUE	UNIT
Reverse Voltage	V_r	2.0	V
Operating Temperature	T_{op}	-10~+60	°C
Storage Temperature	T_{stg}	-40~+85	°C
Lead soldering temperature (10 sec.)	T_{is}	260	°C
Features: <ul style="list-style-type: none"> ⊗ 905nm ⊗ Multi-mode Fiber ⊗ Coaxial or B82 Package ⊗ Built-in PD 			
Applications: <ul style="list-style-type: none"> ⊗ Medical Laser Treatment ⊗ Sensor ⊗ Others 			
Specifications			
	Min	Type	Max
Center Wavelength@25°C	±5nm	905nm	±10nm
Recommend Operating Temperature	25°C		
Output Power	----	50mW	----
Fiber Type	Multi-mode		
Fiber Core	105um(50um,200um Optional)		
Monitor Current	----	0.3mA	----
PD Reverse Voltage	----	----	30V
Fiber Connector	FC/SC/SMA905		
Fiber Length	----	80cm	100cm
Threshold Current (Typ.)	----	25mA	50mA
Operating Current (Typ.)	----	130mA	150mA
Operating Voltage	----	1.9V	2.4V
Package Style	Coaxial or B82		
Photodiodes	Built-in		

Coaxial Package View: (Part Number: WSLP-905-050m-M-PD)

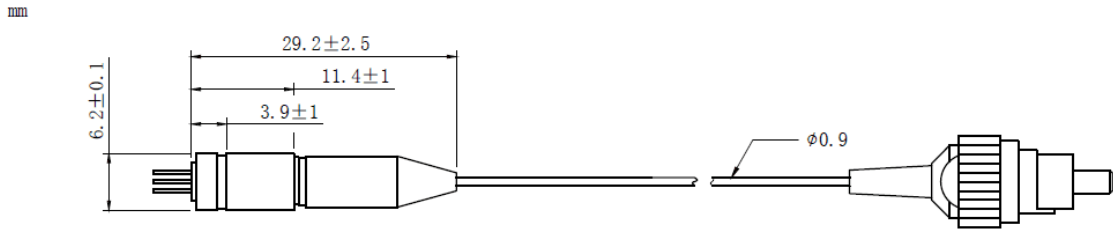

B82 Package View: (Part Number: WSLP-905-050m-M-B-PD)

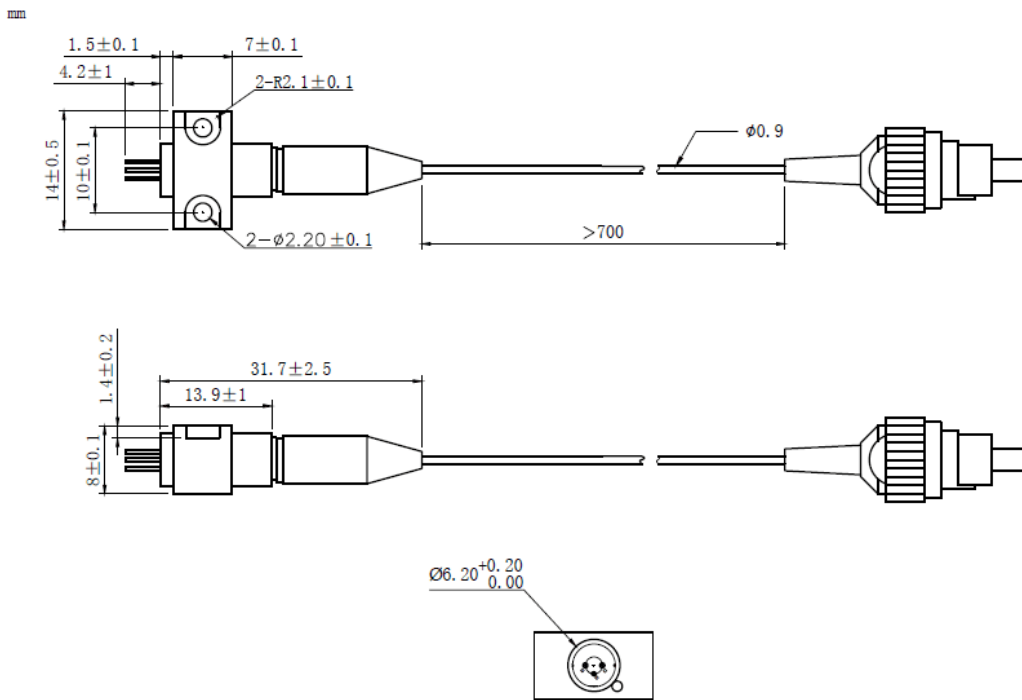

PIN Bottom View:

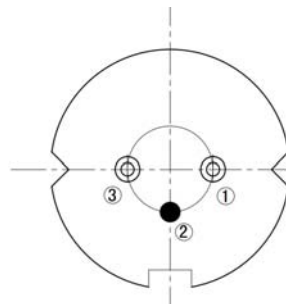

1	LD(-)
2	LD(+)&PD(-)
3	PD(+)

**Electrically shorten LD module and store in non-extreme conditions.
Suggest using the constant current power supply.**

